



# **Multi-Factor Authentication**

# About

## Multi-Factor Authentication

With the increasing frequency of cyber threats, it is critical to adopt stringent security measures to protect sensitive information. SEERMFA offers a state-of-the-art multi-factor authentication solution designed to safeguard your organization against unauthorized access. This innovative system supports multiple authentication methods, providing robust security without sacrificing user convenience. SEERMFA seamlessly integrates with your existing authentication infrastructure, enhancing the security of traditional password-based systems. SeerMFA allows employees to securely access corporate resources from their personal devices. This feature ensures that security is maintained without disrupting productivity, creating a secure and efficient work environment. Boost your organization's defense mechanisms with SEERMFA—crafted to meet the needs of modern, dynamic workplaces.

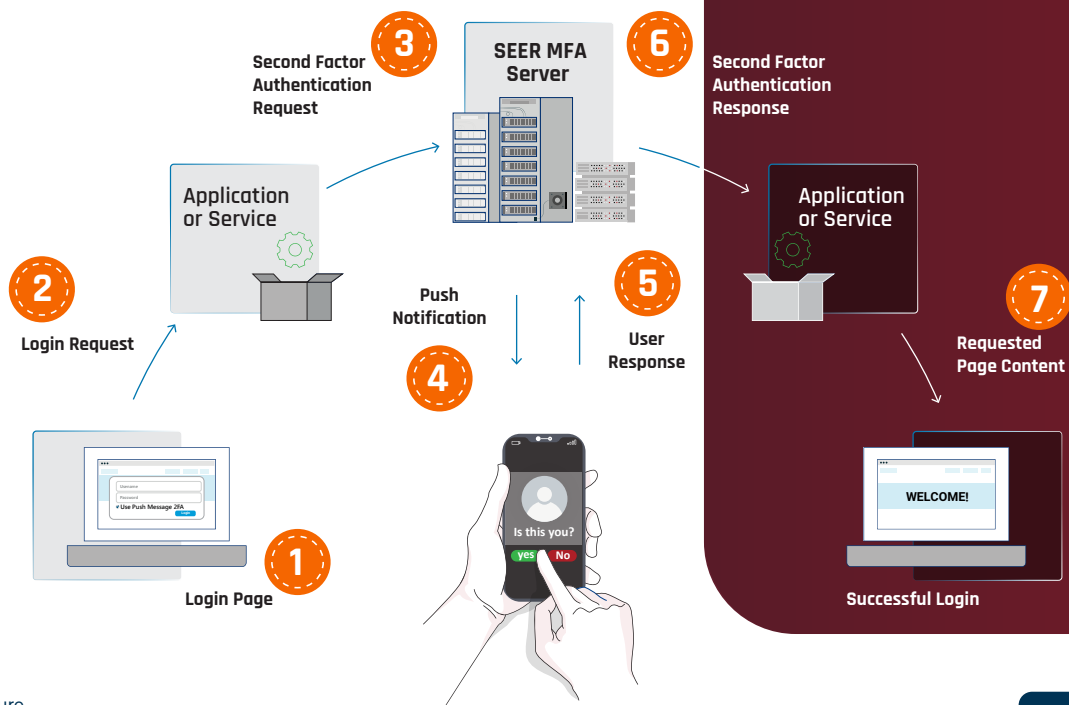

# Product Architecture

## Protection Against Identity Spoofing Attacks

- Social Engineering
- Phishing
- Man-In-The-Middle
- Lost/Stolen Passwords Usage
- Brute-Force Attacks on Passwords

## Diversity of Multi-Factor Authentication Methods

- TOTP and HOTP One-Time Passwords
- Push Notifications
- Passwordless Authentication with a QR Code
- SMS and Email One-Time Passwords

## Diversity of Policy-Making Methods

- System, User, and Group-based Policy Management
- Time and Location
- Internet Service Provider
- Risk
- Unique Identifiers of Mobile Phones

## Reliability

- HA and Load Balancing
- Providing Offline Multi-factor Methods
- Delivering Services with %99.999 Reliability5/
- 8 and 24/7 Post-Sales Support

## Ease of Integration

- Web Applications
- Operating Systems (Linux & Windows)
- Network Infrastructure Equipment (e.g., Cisco, FortiGate, Sophos, etc.)
- Privileged Access Management (PAM) Solutions

## User-friendly and secure

- Android/iOS Mobile Applications
- Multilingual
- Simple Authentication Process with Robust Security
- Enhanced Security through Mobile Phone Biometric Sensors
- Configuration through Self-Service Portal
- Enhanced User Experience

## Event Logging

- Session Logging
- SIEM Integration
- Audit Reports on the Management Dashboard

## Standard and Compliant with Requirements

- Aligned with Standards, Concepts, and Requirements
  - Zero Trust
  - FIDO U2F/UAF

